

DURASTRIPE® GLOW

1.877.ERGOMAT.com

Case Study

Client: Toyota Motor Manufacturing of Indiana

Situation: Toyota required Kaizen floor markings to promote orderly facility evacuation in the case of fire, and efficient assembly in storm shelters in the event of dangerous weather events. Markings had to remain vivid and provide clear direction in the midst of a power failure.

Solution: ERGOMAT supplied Toyota with supplemental pedestrian footprints that were incorporated into the TMMI aisle marking standard. Two supplemental marking formats were provided to be inserted into their pedestrian marking plan as follows:

Fire evacuation directions were indicated on red footprint icons that included directional arrows and text reading FIRE EXIT. Arrows and text were overprinted on a bright and lasting glow-in-the-dark material that complies with DIN64517 Class C, ASTM E2072-04 and ASTM E0203-07 standards.

Directions to designated storm shelters were indicated on green footprints produced in the same way with arrows and text reading STORM SHELTER.

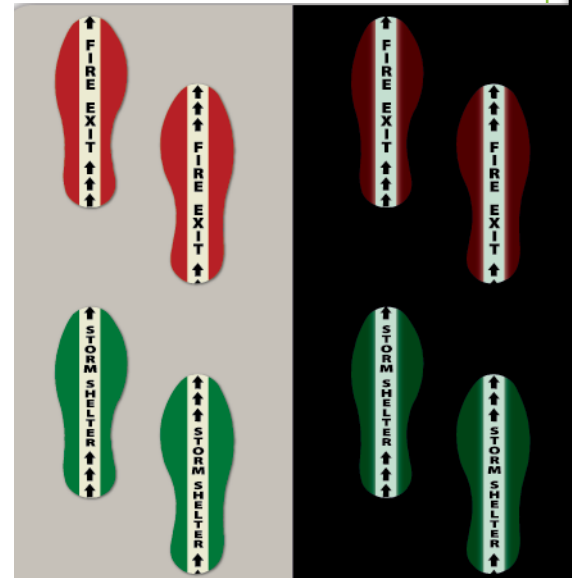

These specially developed materials are an exceptionally effective safety tool because they serve to constantly reinforce employee awareness of safety procedures under normal working conditions. As safety hazards escalate, these markings become significantly more prominent elements in the scheme of plant floor communication.

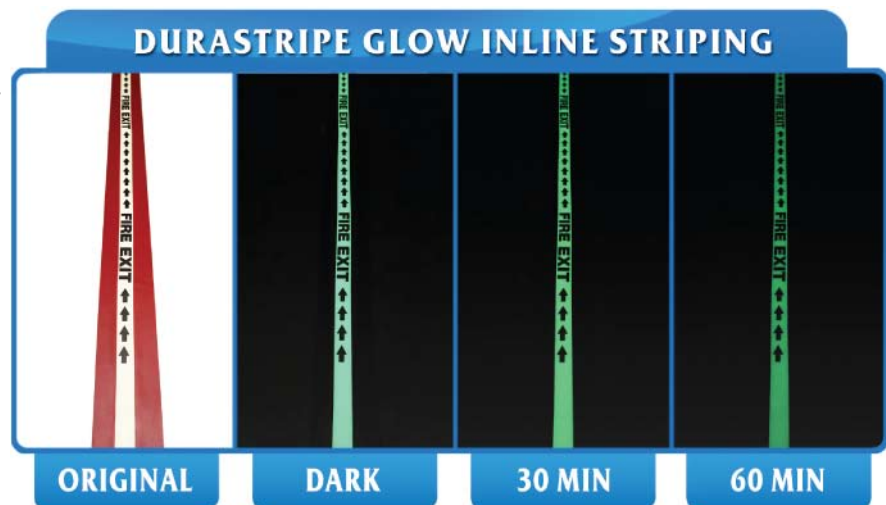

ERGOMAT

www.ergomat.com
info@ergomat.com
 Tel. +1-440-282-4651 (US)
 Tel. +45 70 22 18 40 (DK)

